

## Our Clients

Below are a brief list of clients that our employees provide IT Solutions for



POSCO	MA'ADEN ALCOA	DONGA AUTOMOTIVE
POSTECH	YK STEEL	DAEHAN STEEL
KOREA LOGIS	WILLO	REX MATERIAL
RIST	HWAN-YOUNG STEEL	SEWON STEEL
POSCO ICT	SEKWANG ALUMINUM	SAMIL
POSCO C&C	DONGKUK STEEL MILL	HYUNDAI STEEL



COMMUNICATION FAITH VISION



[Head Office]  
790-826, 3floor, Korea Rural Community Corporation, Sacheonnyeon-daero 422beon-gil, Nam-Gu, Pohang-city,  
Gyeongsangbuk-do, KOREA

TEL +82- 54-231-3500, 3501 / FAX +82- 54-231-3506

[1th Factory]  
790-834, 301room, 2th Laboratory, 394, PohangTP, Jigokro, Nam-Gu, Pohang-city, Gyeongsangbuk-do, KOREA  
Homepage : <http://www.usingtech.co.kr> / E-mail : [usingtech@usingtech.co.kr](mailto:usingtech@usingtech.co.kr)



USINGTECH services shall be used worldwide.



- Factory Automation
- Facility Management
- Environmental Monitoring
- Power & Energy Industry
- Building Automation
- and much more

USINGTECH specializes in the design, installation, modernization and support of automated material handling systems.

We've executed over 27 automated storage / retrieval systems(AS/RS) projects and commissioned over 50 material tracking systems(MTS).

Our project experience spans every industry that uses AS/RS & MTS, including steel industry, aluminum industry and environmental monitoring.

● WMS & MES ●

WMS Solution  
: MAGIC-I  
Warehouse Simulator  
POP Solution  
: MAGIC-P  
MES Solution  
: MAGIC-M

● OODM ●

Software Development for Reuse Methodology  
Object Oriented Development Methodology  
Tools Development for Reuse Methodology

● CONSULTATIONS ●

Establishment of  
- AS/RS  
- MTS  
- MES  
- POP  
Development of  
- Simulation Software  
- Monitoring System

USINGTECH HISTORY



USINGTECH pioneered INDUSTRIAL IT SOLUTIONS 23 years ago.

Who will you trust to provide the best solution?

Registration & prize & authentication

- 2002.12.03 Receive the grand prize (Software and digital-contents contest)
- 2003.03.15 Venture business authentication. (the Small and Medium Business Administration?, Korea Technology Credit Guarantee Fund)
- 2004.12.03 Authentication for innovations in techniques of small and medium-sized businesses (the Small and Medium Business Administration)
- 2005.05.02 Patent registration. (Devices and a way selective a work class.)
- 2005.09.28 Patent registration. (Database work control devices and a way)
- 2008.10 Quality management system authentication. (ISO 9001:2000 / KS A 9001:2007)
- 2009.11 GS authentication. (A warehouse management automation system)

Company History

- 2001.02.23 USINGTECH establishment ? POSTECH inside
- 2001.04.01 Move into POSTECH
- 2003.02.04 Head office workplace transfer. (Pohang Software Assistance center)
- 2003.09.05 Institute of technology establishment.
- 2007.07.07 Factory in Pohang establishment.
- 2012.03.27 Move into POSTECH



Industrial Automation

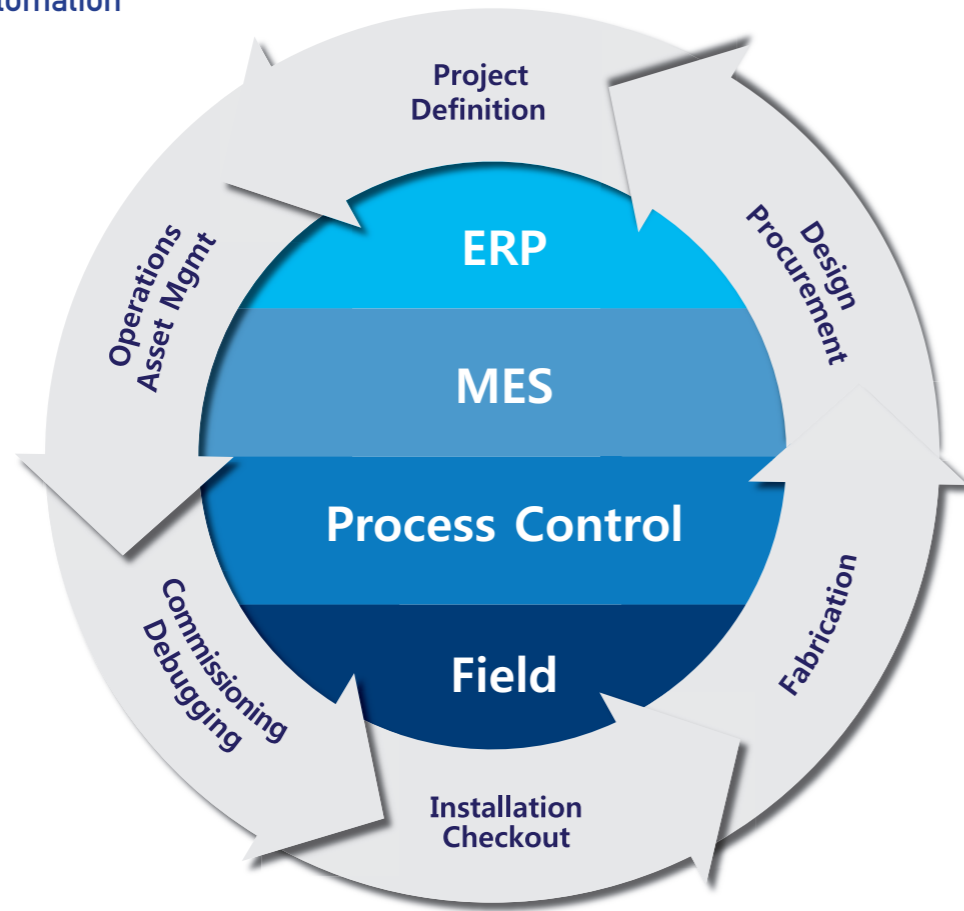

Conceptual Topology – IT View

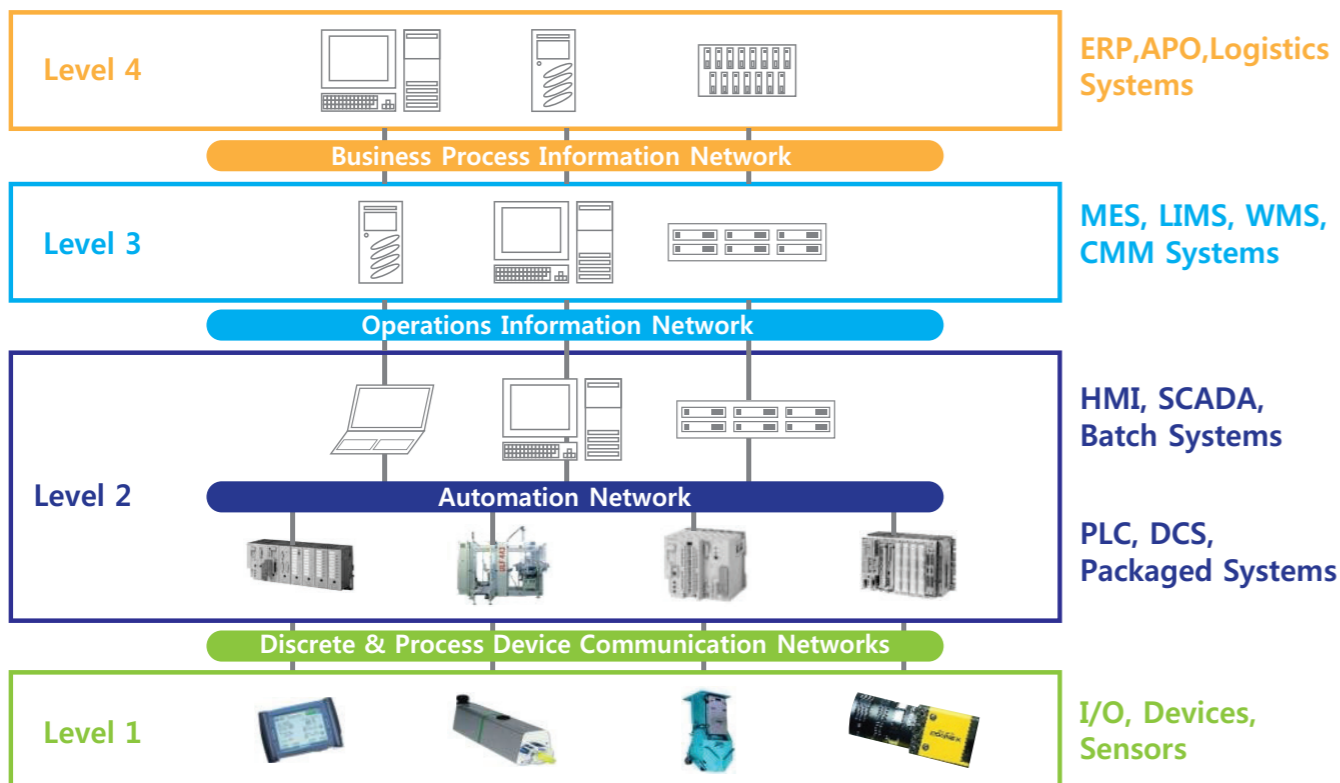

WMOS(Warehouse Management and Automation System)

Steel	Slab	POSCO(1), DONGKUK STEEL MILL(3), POSCO -CDPPC(1)
	Coil	POSCO(5), UNION STEEL(1), POSCO C&C(3)
	Bar	YK STEEL(2), DAEHAN STEEL(1), HWANYOUNG STEEL(3), SEWON STEEL(1)
Automotive		DONG -A AUTOMOTIVE(2)
Raw Material		POSTECH -PAL(1), DAEHAN STEEL(1)
Rice Cooker		SEWWANG ALUMINUM(1)
Paint		REX Material(1)

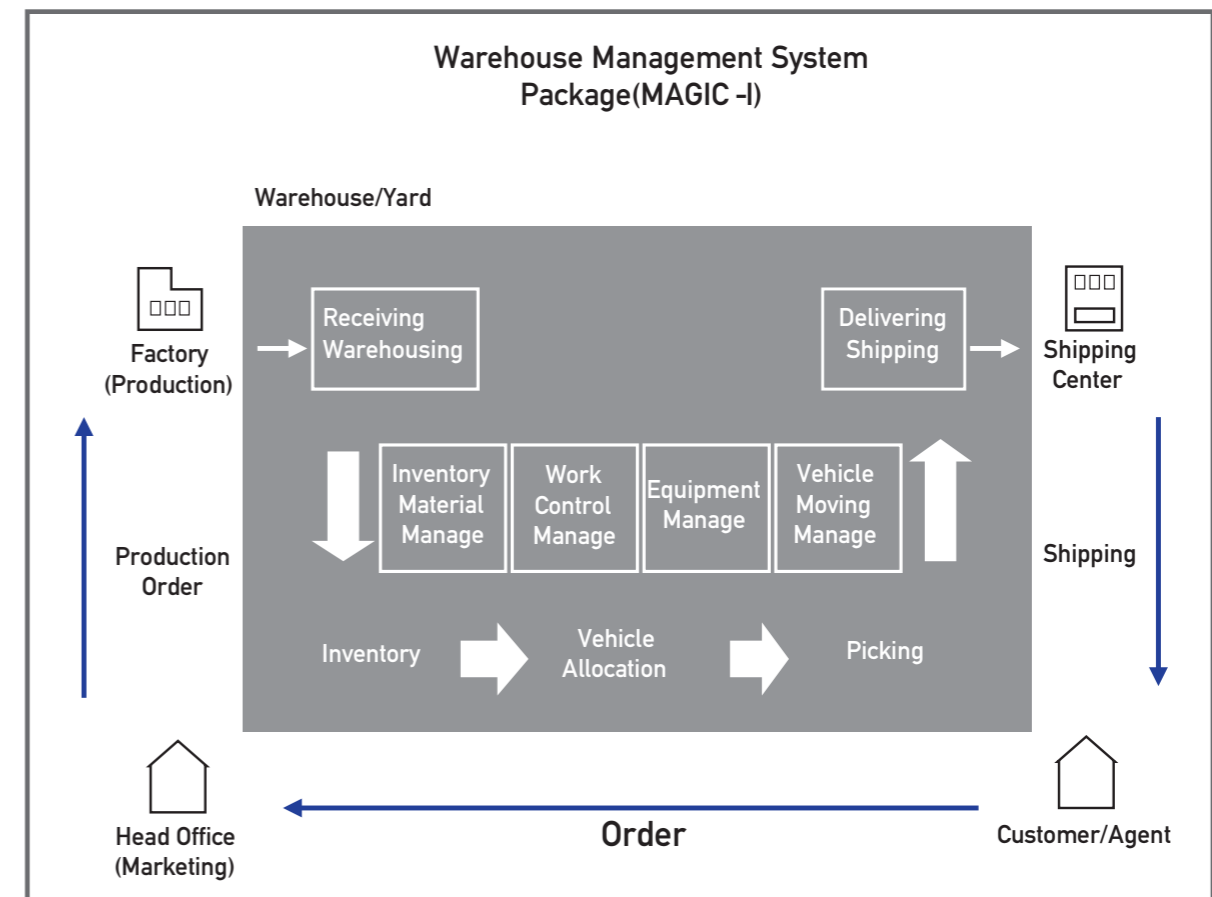

## ■ Cyber warehouse management system (Web)

Cyber warehouse management system (Web)

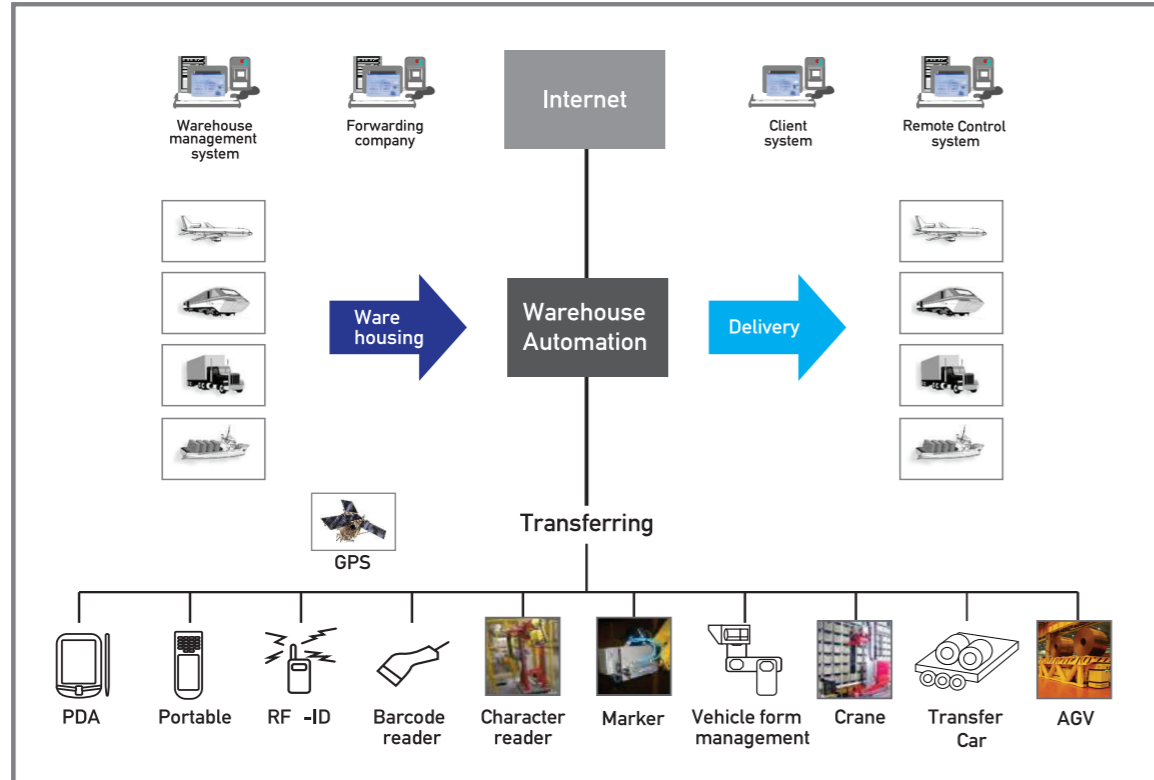

## ■ Palletless Steel-Plate Storage System

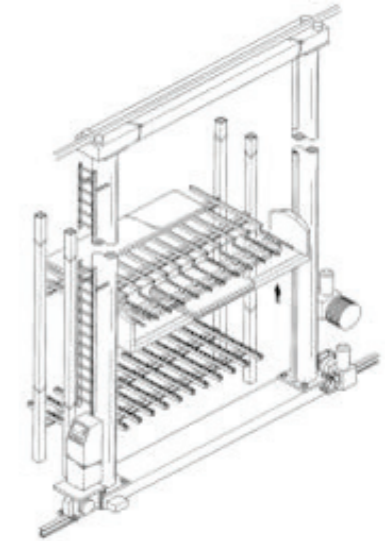
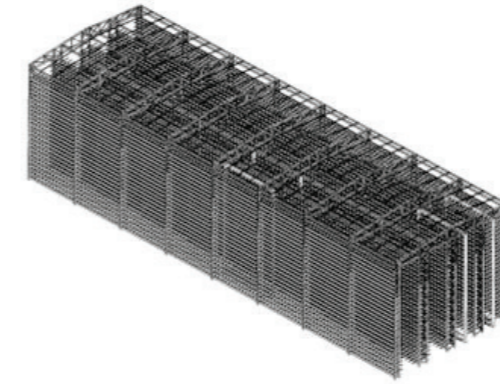

- WMOS are good for maximizing space
- WMOS save times and money
- WMOS are a growing market

## ■ Track & Trace in the FIELD ( using 2-D Data Matrix )



- 2-D Data Matrix represents the next generation of automatic identification.
- More error correction
- More data ? smaller area!

## ■ Labeling/Marking and Reading System

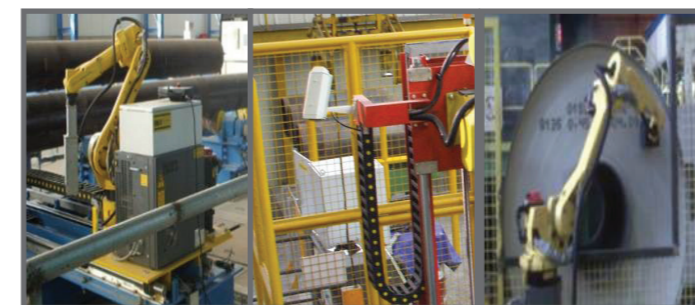

Marking Robot & Reading Camera



Data Matrix marking on Aluminum Coil



Straight Marking

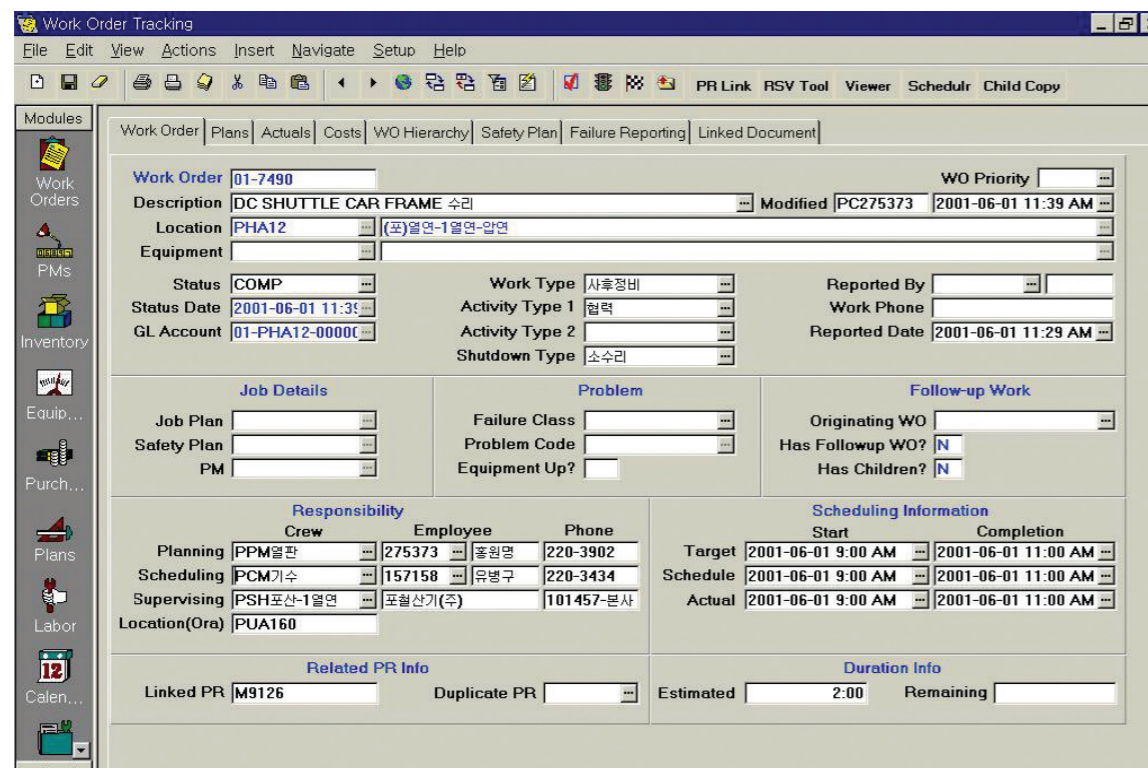

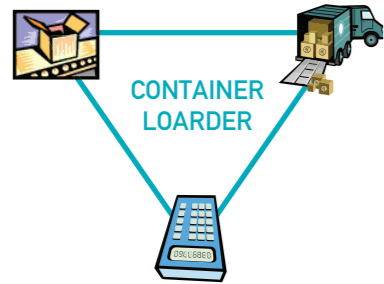

- Container Loader
- Container Loader Engine
- Loading Algorithm
- 3D Display Mouse control

- Powerful Engine applied scientific theory to solve loading difficulties
- 3 dimension solution considering priority
- Available to service Web-based Monitoring information to Loader
- 3D display on timely
- Ease operation (mouse control)

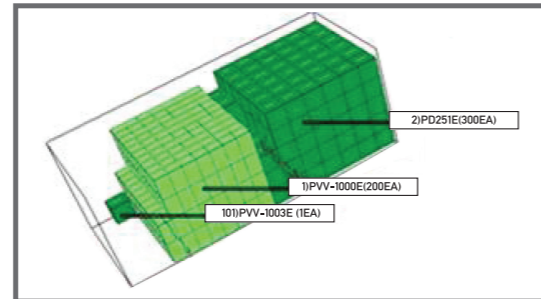
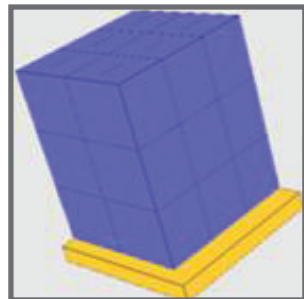

The Development of High Efficiency Smart EAF for Energy Saving

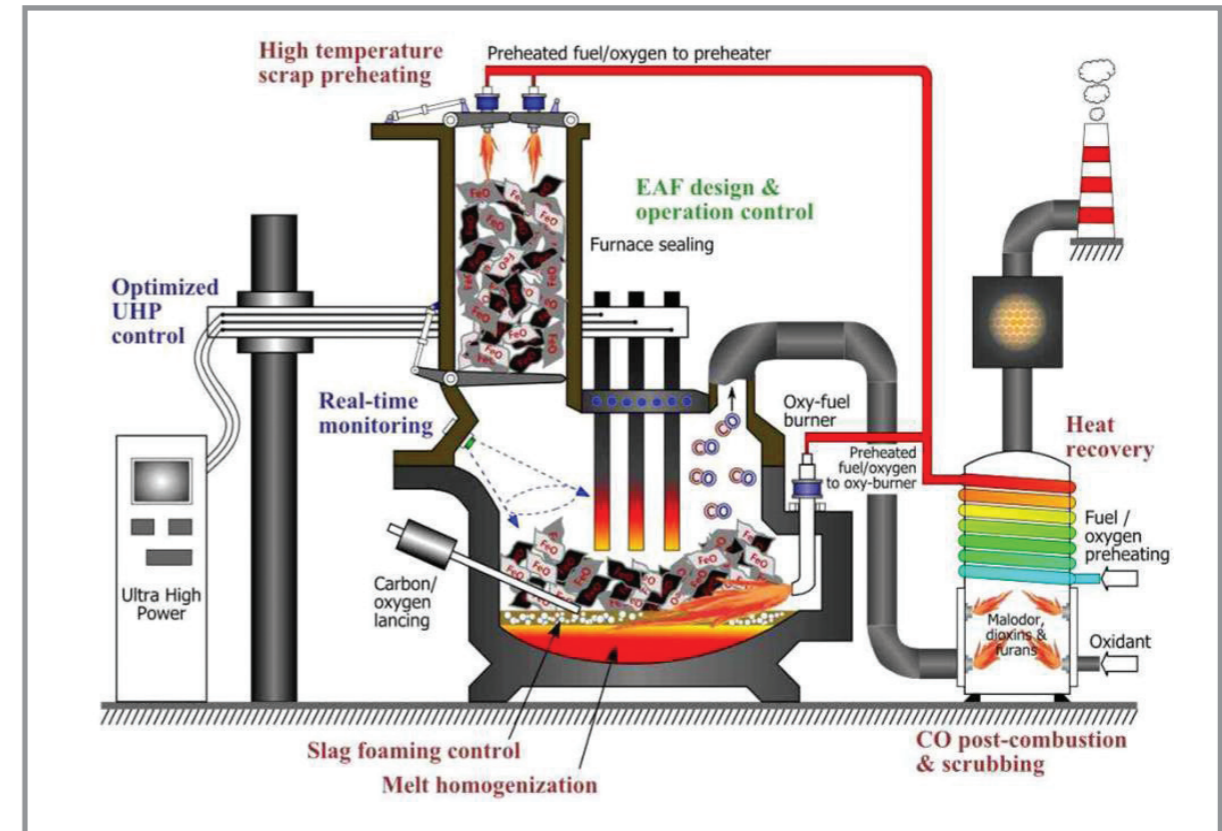

The Development of Electrode Bar Control System for Energy Saving

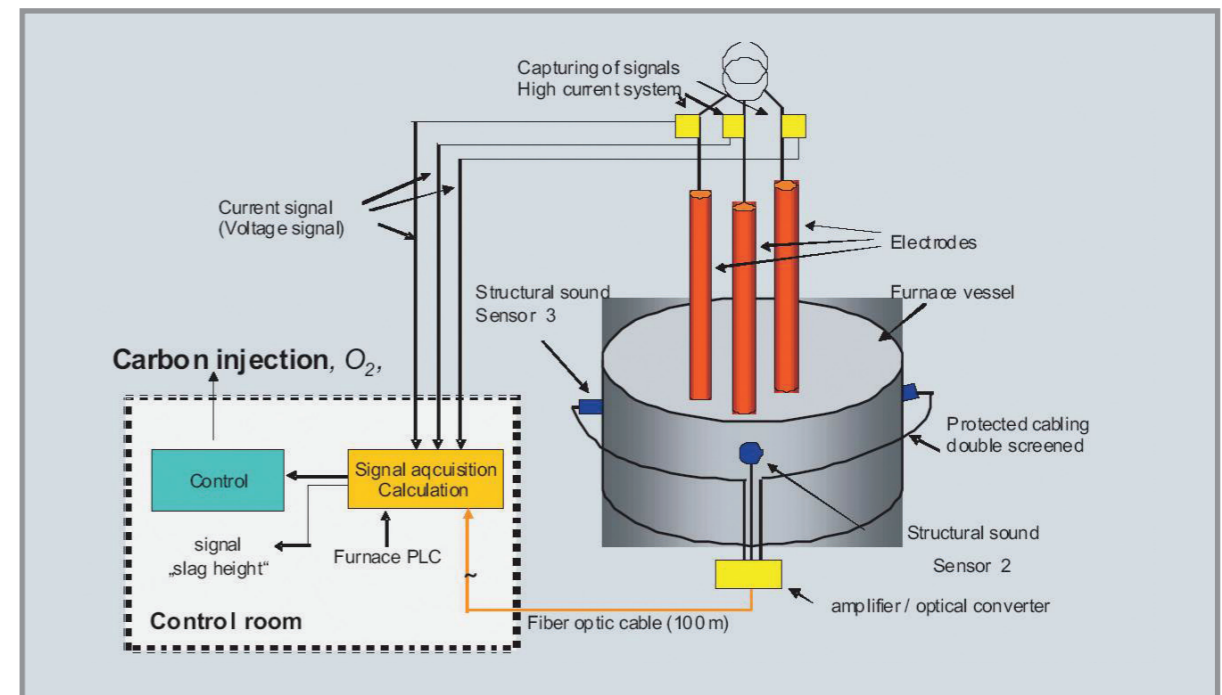

EAF (Electric Arc Furnace)

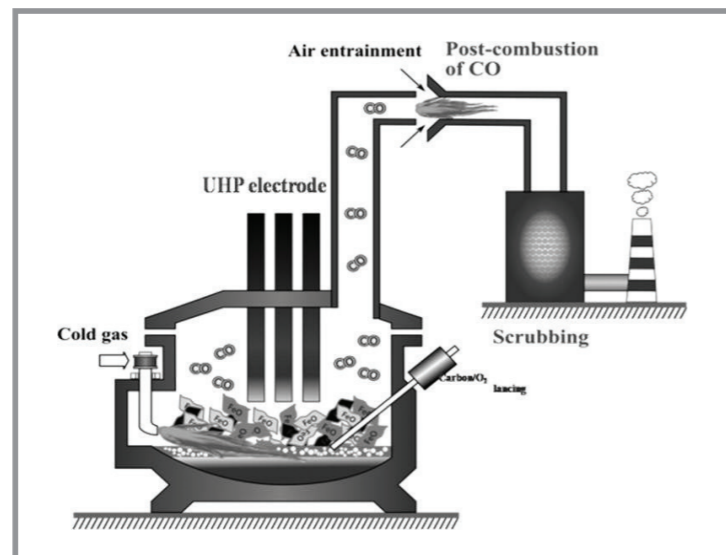

The Monitoring & The Electricity Measurement & Quality Analysis

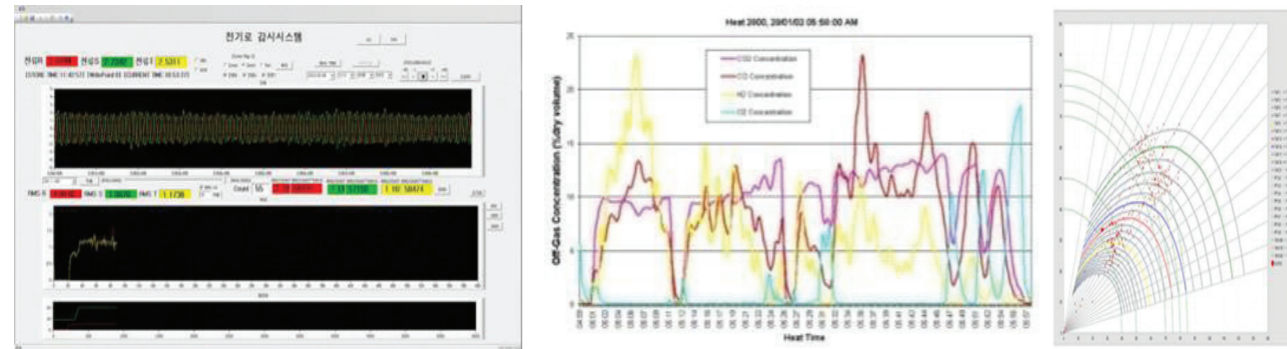

The Scale Measuring Equipment of Thick Plate

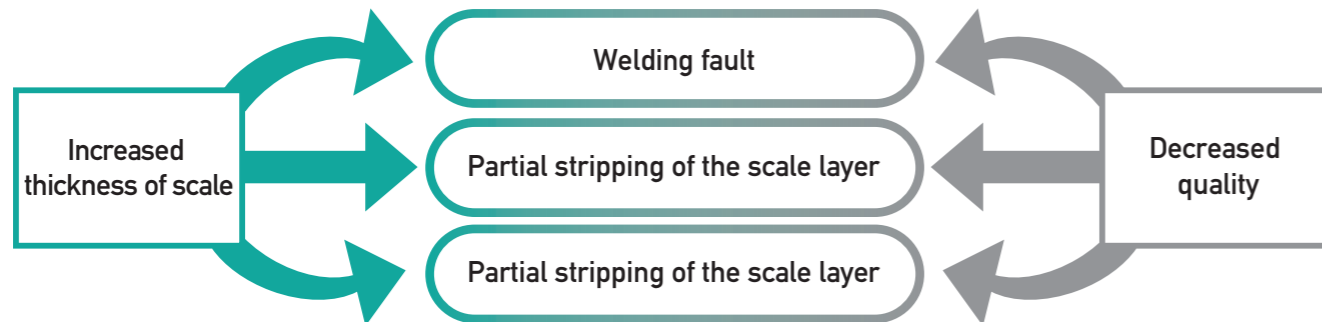

Expected effect

- Easy management of measurement data
- Improved productivity and quality
- Minimized production loss
- Enhanced reliability for customer's products

Electric Control & Inventory Automation System

No.	Nation	Company	Project	Year
1	Korea	POSCO	WMS for Slab/Coil Yard in No.2 Hot Mill plant	1989
2	Korea	POSCO	WMS for Slab Yard in No.2 Thick Plate plant	
3	Korea	POSCO	WMS for Cast Strand Yard in No.3 Continuous Casting plant	
4	Korea	POSCO	Slab Yard Automation System Packages	1998
5	Korea	POSTECH	Slab Yard Automation System Packages	2001
6	Korea	MOTIE	Object Oriented Components for Industrial use	
7	Korea	KOREA LOGIS	Bertelsman Book Warehouse Management System	
8	Korea	SMBA	A Simulation model of Warehouse Management System	
9	Korea	POSCO	A Static model for Blowing control	2003
10	Korea	POSCO	Steelpia Framework	
11	Korea	POSCO	A Dynamic model for Excess Gas	
12	Korea	POSCO	Unmanned WMS for Incoming Yard in Tin-Plate plant	
13	Korea	POSCO	Unmanned WMS in F-building of No.2 Thick Plate plant	
14	Korea	POSCO C&C	Automatic Inventory Management System for No.2 CGL (Continuous Galvanizing Line)	
15	Korea	SMBA	A Component-based MES for steel plant	2004
16	Korea	POSTECH	Material Warehouse Management System of PAL(Pohang Accelerator Laboratory)	
17	Korea	POSCO	Unmanned WMS for Products Warehouse of No.2 Hot Mill plant in Gwangyang plant	
18	Korea	POSCO	Unmanned WMS of Re-Structured No.2 Thick Plate plant	
19	Korea	MOTIE	Components Supporting Tools for Steel industry	2005
20	Korea	YK STEEL	Product Warehousing Automation System	
21	Korea	WILLO	Container Loading Optimization System	
22	Korea	POSCO	Unmanned WMS for Incoming Yard in Electrical Steel Sheet plant	2006
23	Korea	POSCO	Unmanned Automation System using AGV for Steel Industry	
24	Korea	POSCO	AGV Management System of No.1 Cold Mill plant	
25	Korea	POSCO	A thermal efficiency monitoring system of oxygen plant	
26	Korea	POSCO	A special test management system	2006
27	Korea	Hwan-Young Steel Ind	An Outbound WMS	
28	Korea	SEKWANG ALUMINUM	Product WMS	
29	Korea	DONGKUK STEEL MILL	WMS of Pohang Thick-Plate plan	

■ Electric Control & Inventory Automation System

No.	Nation	Company	Project	Year	
30	Korea	POSCO	1 <sup>st</sup> stage unmanned crane operating system in Pohang plant and interlocks between mobile station and ground equip.	2006	
31	Korea	POSCO	Restructuring of Control PLC of Roller Leveler in No.2 Thick Plate plant		
32	Korea	POSCO	Unmanned Crane Operation System for T4 cranes of No.2 Continuous Casting plant Electric Control & Inventory Automation System		
33	Korea	UNION STEEL	MTS(Material Tracking System)		
34	Korea	POSCO	PDA for correction of No.2 Thick plate plant		
35	Korea	POSCO	AS/RS(Automated Storage and Retrieval System for product warehouse of No.2 Thick plate plant		
36	Korea	DONGA AUTOMOTIVE	Product WMS for Automotive		
37	Korea	POSCO C&C	Automatic Inventory Integration System for Color Steel Plate plant		2007
38	Korea	POSCO ICT	MTS(Material Tracking System) using RFID		2008
39	Korea	DAEHAN STEEL	MTS(Material Tracking System)		
40	Korea	POSCO	Heavy Vehicle Control system for heavy thick plates of No.2 Thick plate plant		
41	Korea	REX Material	Product WMS		
42	Korea	POSCO	Integrated Mobile Station for correction of Thick plate plant		
43	Korea	POSCO	Control System for Incoming and Outgoing Vehicles using RFID		
44	Korea	POSCO	Unmanned Gantry Crane Control PLC for No.2 Thick Plate Plant		
45	Korea	POSCO	Performance Control System in STS APL (Annealing & Pickling Line)		
46	Korea	POSCO	2 <sup>nd</sup> stage unmanned crane operating system in Pohang plant (PLC, mobile station and vehicle positioning)		
47	Korea	SEWON STEEL	WMS for Steel Bar machining plant		
48	Korea	POSCO	AS/RS (Automated Storage and Retrieval System for Container Transform Warehouse)	2009	
49	Korea	POSCO	Access Control System using RFID for Laboratories		
50	Korea	POSCO	Unmanned S/Y Crane Control PLC for No.1 Hot Mill Plant		
51	Korea	POSCO	Unmanned Crane Control PLC for Electrical Steel Sheet Plant		
52	Korea	POSCO	AGV Management System of No.1 Cold Mill plant		
53	Korea	DONGKUK STEEL MILL	WMS for Slab Yard in DANGJIN Thick Plate plant		
54	Korea	POSCO	WMS for correction of Thick plate plant in NEW STEEL PLANT		

■ Electric Control & Inventory Automation System

No.	Nation	Company	Project	Year
55	Korea	POSCO	Unmanned Overhead and Auto Pickup Crane for STS Cold Mill Plant	2009
56	Korea	POSCO	Access Control System using RFID for FINEX plant	
57	Korea	POSCO	WMS for correction of No.3 Continuous Casting plant	
58	Korea	ONE-JUNG CAN MANUFACTURING	Defect Removal Automation System	
59	Korea	POSCO	Access Control System using RFID for GWANGYANG plant	
60	Korea	POSCO	WMS for Slab Yard in Thick Plate plant of GWANGYANG plant	
61	Korea	DONGKUK STEEL MILL	WMS PDA in DANGJIN Thick Plate plant	
62	Korea	POSCO	Vehicle Control System of NEW STEEL PLANT	
63	Korea	POSCO	Thickness Control System in Thick Plate plant	
64	Korea	POSCO	Perspective Manager	
65	Korea	POSCO	Thickness Control System for Cast Strand	2010
66	Korea	POSCO	Energy Holder Control System (PLC, HMI and IPC)	
67	Korea	POSCO	Laser Line welder System	
68	Korea	HYUNDAI STEEL	Charging Apparatus Control System	
69	Korea	POSCO	Unmanned Auto Pick-Up Control System of No.2 Continuous Casting plant	
70	Korea	NFRI	Netural Beam Heating Apparatus Control System for KSTAR in NFRI (National Fusion research Institute)	
71	Korea	DAEHAN STEEL	MTS(Material Tracking System) in Pyeongtak plant	
72	Korea	POSCO	Thickness Measuring System in Thick Plate plant	
73	Korea	POSCO CDPPC	WMS of Raw Material Yard in Thick Plate plant	
74	Korea	POSCO	Door Service Car Management System of Raw Material Plant	
75	Korea	POSCO	MTS(Material Tracking System) using RFID in Pohang plant	2011
76	Korea	POSCO	MTS(Material Tracking System) using RFID in Gwangyang plant	
77	Korea	POSCO	3 <sup>rd</sup> stage unmanned crane operating system (PLC, mobile station and vehicle positioning)	
78	Korea	POSCO	GPS System of Laser Line welder System	
79	Korea	POSCO	Control System of LNG Combined Power Generation Facility	
80	Korea	POSCO	Establishment of Electric Furnace Current Measuring System & Cable Record management System	
81	Korea	POSCO	Restructuring of On-Line Scale Thickness Measuring Equipment for Extreme Environment	

## PROJECT REFERENCE

### Electric Control & Inventory Automation System

No.	Nation	Company	Project	Year
82	Korea	SAMIL	Establishment of Unmanned WMS for Steel-Coil Auto warehouse	2011
83	Korea	POSCO	Renewal and Restructuring of Deteriorated Automation Facilities	2012
84	China	HYUNDAI STEEL	Charging Apparatus Control System	
85	Korea	POSCO C&C	Establishment of Yard & Inventory WMS for Color Steel Plate plant	
86	Korea	POSCO	Remodeling of Mathematical Model for Hot Roll Mill	
87	Korea	DAEHAN STEEL	MTS(Material Tracking System) in Pyeongtak plant	
88	Saudi	Ma' aden &ALCOA	MTS(Material tracking System) for Aluminum Mill Plant	
89	Korea	POSCO	Crane Operating System for No.4 STS Steel Making	
90	Korea	POSCO	Crane Operating System for No.4 Continuous Steel Making	
91	India	POSCO-IDPC	Manned WMS for Coil Yard of Cold Mill Plant	
92	Brazil	CSP	Unmanned Control System of Transfer Car of Raw Material Yard	
93	Korea	POSCO	Unmanned Control System of Transfer Car of No.4 STS Yard	
94	Korea	POSCO	Unmanned Control System of Transfer Car of Annealing Pickling Plant	
95	Korea	KOMERA	Development of Hybrid continuous steelmaking process	
96	Korea	KETEP	Demonstration of Thermo-chemically Enhanced Smart EAF Technology for Electrical Load Reduction	
97	Korea	SMBA	Development of Automation System for Defect Elimination	
98	Korea	POSCO	Crane Operating System for STS No.4 Continuous Steel Making	
99	Korea	POSCO	Gas Management System	
100	Korea	LOTTE E&C	Monitoring and Control System for Reusing of domestic sewage	
101	Inni	POSCO-PT-KR	Monitoring and Control System for The Environment	
102	Korea	POSCO	Quantification System of Raw Material and Electricity In Enclosed EAF	2014
103	Korea	POSCO	The Development of Electrode Bar Control System in DC EAF	
104	Korea	POSCO	Development of The Monitoring System for The Total Security	
105	Brazil	POSCO	Development & Supervising for Control PLC of T-Car	
106	Korea	POSCO	Improvement of Induction Furnace of STS No. 4 STS Steel Making	
107	Korea	SMBA	The Development of The General WMS	

USINGTECH services shall be used worldwide.

